



The Schimberg Group Inc.

Architecture. Interior Design.
Owner Representation. LEED Consulting.

FL# AR 92705

July 2011

www.tsg-fl.com | [TSG-Blog](#)

COLLABORATIVE METHODS
A MONTHLY NEWSLETTER

Dear [member_name_first],

Welcome to our July 2011 edition. This monthly newsletter showcases design solutions that The Schimberg Group provides to its clients. The Schimberg Group understands that collaboration is fundamental towards achieving best practices, sustainable success and **Extraordinary Results**.

President's Corner: **YOU HAVE ARRIVED**

"Arrival represents a partial objective of the overall goal of arriving at the final destination. For the designer, there are opportunities to make the arrival memorable, to reveal the whole cohesively, and to make the path clear for visitors, among others."

*-Roberto J. Rengel
Shaping Interior Space*

When designing a lobby or entry, the sign and reception area provide an opportunity to both reflect a company's philosophy using aesthetics and create an important first impression. By using different materials and shapes, in conjunction with the company's logo, the client can achieve their design goals.

*-Barron Schimberg, AIA
Leed AP*

Featured Projects:



ABOVE: ENTRY SIGN FOR A FINANCIAL INSTITUTION BY THE SCHIMBERG GROUP



ABOVE : ENTRY SIGN FOR MEDIA GROUP DESIGNED AND INSTALLED BY THE SCHIMBERG GROUP

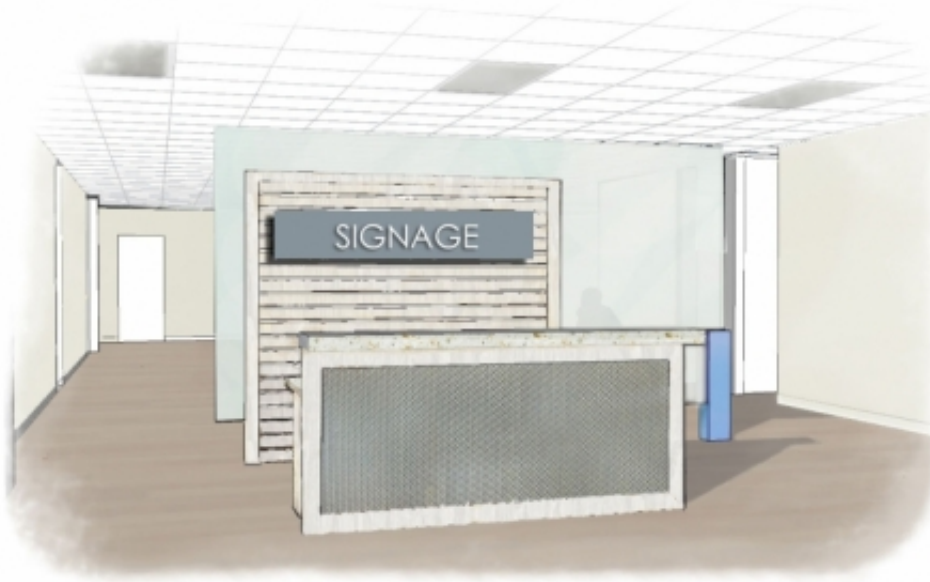

ABOVE : ENTRY SIGN DESIGN FOR NEW TENANT FINISH OUT BY THE SCHIMBERG GROUP

Please visit our blog to participate in discussions about architecture, sustainability, and our built environment. [TSG-Blog](#)

We look forward to working with you to create architectural solutions that exceed your expectations.

Sincerely,

Barron Schimberg, AIA
LEED AP
The Schimberg Group, Inc.
Collaborative Methods. Extraordinary Results.



Featured in Green Retail Design by Martin Pegler. Click [HERE](#) To Reserve Your Copy.